

Belmont Road 18 Belmont Road

London N15 3LT
 bathrooms 1
 205.00 sqft
 19.04 sqm
 available from 01/10/2024

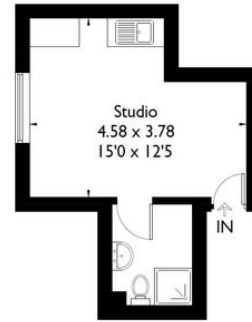

Flat 8, 18 Belmont Road, Turnpike Lane, N15 3LT
 Approximate Gross Internal Area
 19 sq m / 205 sq ft



FIRST FLOOR

FLOORPLANZ © 2014 0845 614080 Ref: 13795
 This plan is for layout guidance only. Drawn in accordance with RICS guidelines. Not drawn to scale unless stated. Windows & door openings are approximate. Voided every care is taken in the preparation of this plan, please check all dimensions, shapes & compass bearings before making any decisions reliant upon them.

+44 7776 659028

rent

total rent
 deposit

GBP 1,100
 GBP 1,269.23

apartment

pets
 furnished state
 built-in kitchen
 washing machine
 washer dryer

not allowed
 unfurnished

building

construction year
 bike room

1890

energy

energy efficiency rating C

distance, feet

closest underground station	Turnpike lane station	
daily shop		0.1
school		0.1
shopping center		0.1

