

Hoe Lane

London EN1 4JL
floor 2 out of 1
bedrooms 1
bathrooms 1
346.60 sqft
32.20 sqm
available from 24/02/2025

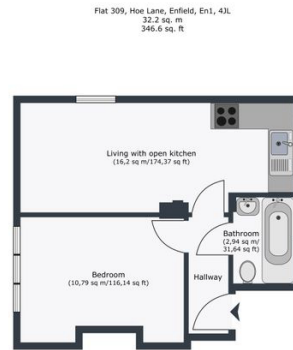

Layout and measurements are approximate only and for illustrative purposes only.

+44 7557 858704

rent

total rent
deposit
additional rent for
pets

GBP 1,375
GBP 1,586.54
GBP 40

apartment

pets
furnished state
built-in kitchen
washer dryer

only cats allowed
unfurnished

building

construction year 1961

parking

parking space rent
parking space

GBP 40
to rent

energy

energy efficiency rating D

distance, feet

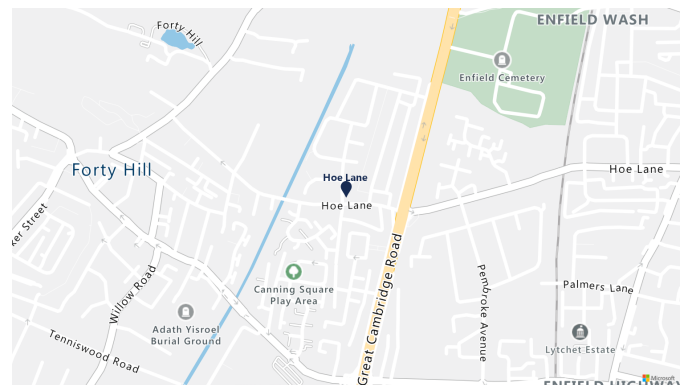

closest
underground
station

Turkey Street



