

Cobbett Close

London EN3 6QT
bedrooms 1
bathrooms 1
409.00 sqft
38.00 sqm
available from 16/05/2026

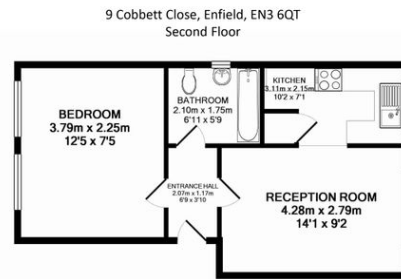

TOTAL APPROX. FLOOR AREA 34.9 SQ.M. (376 SQ.FT.)
Whilst every attempt has been made to ensure the accuracy of the floor plan contained here, measurements of doors, windows, rooms and any other items are approximate and no responsibility is taken for any error, omission, or mis-statement. This plan is for illustrative purposes only and should be used as such by any prospective purchaser. The services, systems and appliances shown have not been tested and no guarantee as to their operability or efficiency can be given.
Made with Metropix ©2015

+44 7557 858704

rent

total rent GBP 1,450
deposit GBP 1,673.08

apartment

pets only cats allowed
furnished state unfurnished
dishwasher
washer dryer

building

construction year 1950
garden communal garden
bike room

parking

parking space rent GBP 50
parking space to rent

energy

energy efficiency rating C

distance, feet

closest Turkey Street
underground station

