

# Flat 5 50-52 St Quintin Avenue

London W10 6PA  
bathrooms 1  
166.80 sqft  
15.50 sqm  
available from now on

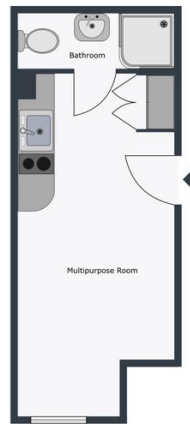

Flat 5, 50-52 St Quintin Avenue, London, W10 6PA



Layout and measurements are approximate only and for illustrative purposes only.

+44 7778 470998

rent

total rent  
deposit

GBP 1,295  
GBP 1,494.23

apartment

pets  
washer dryer

not allowed

building

construction year

1900

energy

energy efficiency rating C

