

28 rue Hermel

75018 Paris
floor 1 out of 6
227.12 sqft
21.10 sqm
available from now on

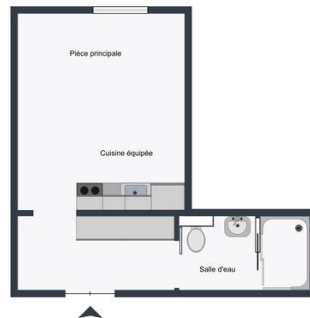

+33 7 88 29 46 18

rent

base rent	EUR 709
additional rent	EUR 86
operational costs	EUR 35
total rent	EUR 830
deposit	EUR 795
rent increase reference	33,6 EUR / sqm
notice period	one month

apartment

- store room
- built-in kitchen
- microwave
- washing machine

building

construction year 1900

energy

energy efficiency rating E	
date of certificate	08/04/2024
current energy consumption	262 kWh/m ² *a
gas efficiency rating B	
current gas	8 kgeqCO ₂ /m ²

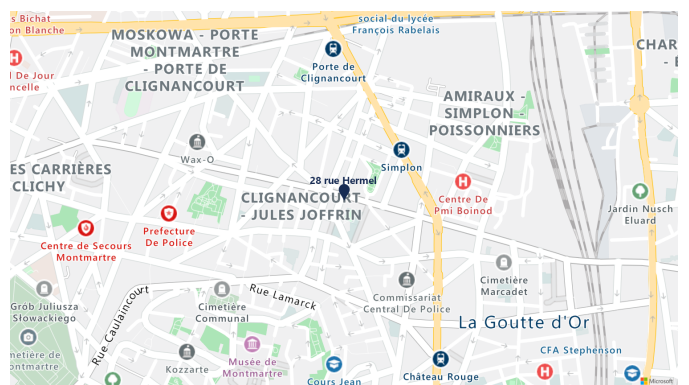

consumption
min annual energy consumption cost EUR 410
max annual energy consumption cost EUR 580
energy consumption reference date 01/01/2021

distance, meters

closest subway station Jules Joffrin
subway 50

