

28 rue Hermel

75018 Paris
floor 1 out of 7
201.93 sqft
18.76 sqm
available from now on

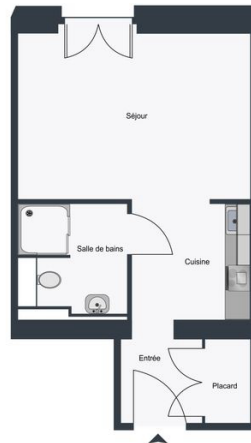

+33 7 88 29 46 18

rent

| | |
|-------------------|----------------|
| base rent | EUR 630 |
| additional rent | EUR 296 |
| operational costs | EUR 40 |
| total rent | EUR 966 |
| deposit | EUR 926 |
| rent increase | 33,6 EUR / sqm |
| reference | |
| notice period | one month |

apartment

| | |
|------------------|---------|
| flooring | parquet |
| built-in kitchen | |
| washing machine | |

building

| | |
|-------------------|------|
| construction year | 1900 |
|-------------------|------|

energy

| | |
|----------------------------|---------------------------------------|
| energy efficiency rating E | |
| date of certificate | 29/11/2019 |
| current energy consumption | 323 kWh/m ² *a |
| gas efficiency rating B | |
| current gas consumption | 7 kgeqCO ₂ /m ² |



annual energy consumption cost EUR 382
energy consumption reference date 15/08/2015

distance, meters

closest subway station Jules Joffrin
subway 100

