

# 28 rue Hermel

75018 Paris  
floor 1 out of 7  
220.55 sqft  
20.49 sqm  
available from now on

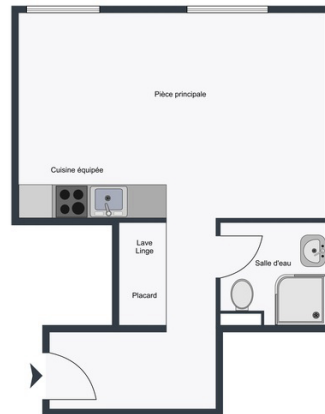

+33 7 88 29 46 18

## rent

base rent	EUR 672
additional rent	EUR 193
operational costs	EUR 30
total rent	EUR 895
deposit	EUR 865
rent increase	32,8 EUR / sqm
reference	

## apartment

built-in kitchen  
washing machine

## building

construction year 1900

## energy

energy efficiency rating C	
date of certificate	08/02/2023
current energy consumption	179 kWh/m <sup>2</sup> *a
gas efficiency rating A	
current gas consumption	5 kgeqCO <sub>2</sub> /m <sup>2</sup>
min annual energy consumption cost	EUR 317

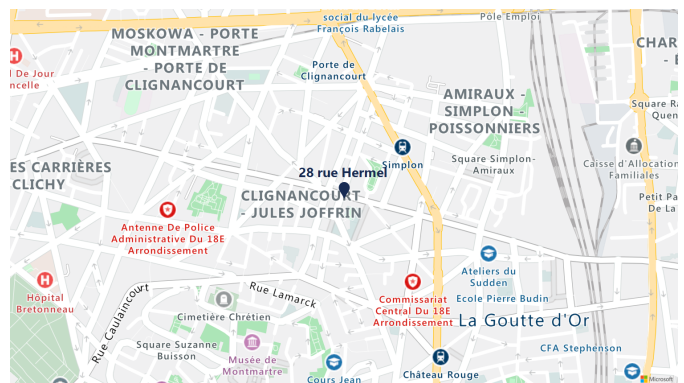

max annual energy  
consumption cost  
energy  
consumption  
reference date

EUR 429

01/01/2021

distance, meters

closest subway  
station  
subway

Jules Joffrin

50



