

# 28 rue Hermel

75018 Paris  
floor 4 out of 7  
215.71 sqft  
20.04 sqm  
available from now on

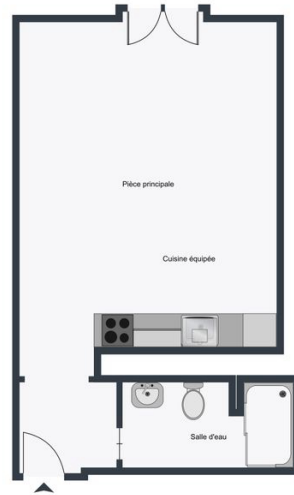

+33 7 88 29 46 18

## rent

base rent	EUR 673
additional rent	EUR 298
operational costs	EUR 49
total rent	EUR 1 020
deposit	EUR 971
rent increase reference	33,6 EUR / sqm
notice period	one month

## apartment

store room  
built-in kitchen  
dishwasher  
microwave  
washing machine

## building

construction year 1900

## energy

energy efficiency rating C  
date of certificate 17/09/2024  
current energy consumption 146 kWh/m<sup>2</sup>\*a  
gas efficiency rating A

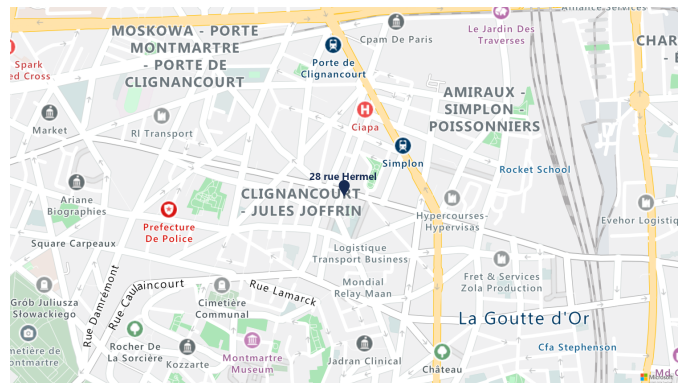

current gas consumption 4 kgeqCO2/m<sup>2</sup>  
min annual energy consumption cost EUR 343  
max annual energy consumption cost EUR 465  
energy consumption reference date 01/01/2021

### distance, meters

closest subway station Jules Joffrin  
subway 50

