

# 28 rue Hermel

75018 Paris  
floor 4 out of 6  
200.64 sqft  
18.64 sqm  
available from now on

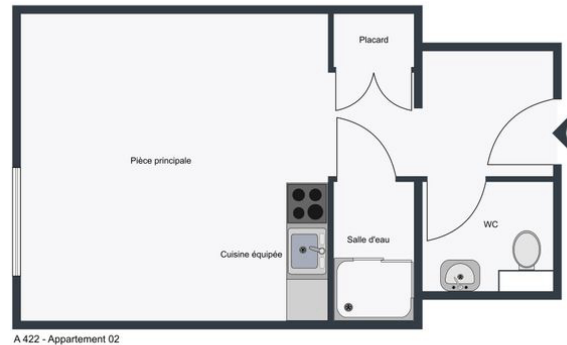

A 422 - Appartement 02

+33 7 88 29 46 18

## rent

base rent	EUR 647
additional rent	EUR 193
operational costs	EUR 30
total rent	EUR 870
deposit	EUR 840
rent increase	34,7 EUR / sqm
reference	
notice period	one month



## apartment

store room  
built-in kitchen  
microwave  
washing machine

## building

construction year	1900
-------------------	------

## energy

energy efficiency rating C	
date of certificate	07/01/2026
current energy consumption	225 kWh/m <sup>2</sup> *a
gas efficiency rating B	
current gas consumption	8 kgeqCO <sub>2</sub> /m <sup>2</sup>

min annual energy consumption cost                    EUR 470  
max annual energy consumption cost                    EUR 650  
energy consumption reference date                    01/01/2021

distance, meters

closest subway station                    Jules Joffrin  
subway                    50





