

28 rue Hermel

75018 Paris
floor 4 out of 6
bedrooms 1
344.99 sqft
32.05 sqm
available from now on

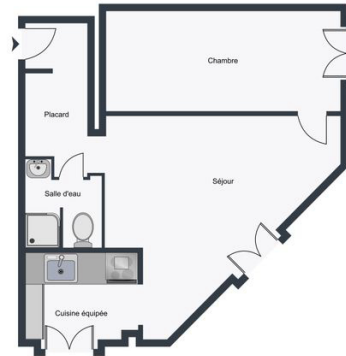

+33 7 88 29 46 18

rent

| | |
|-------------------|----------------|
| base rent | EUR 945 |
| additional rent | EUR 450 |
| operational costs | EUR 70 |
| total rent | EUR 1 465 |
| deposit | EUR 1 395 |
| rent increase | 29,5 EUR / sqm |
| reference | |
| notice period | one month |

apartment

store room
built-in kitchen
dishwasher
microwave
washing machine

building

| | |
|-------------------|------|
| construction year | 1900 |
|-------------------|------|

energy

| | |
|----------------------------|--------------|
| energy efficiency rating D | |
| date of certificate | 18/08/2023 |
| current energy consumption | 196 kWh/m²*a |



gas efficiency rating B
current gas consumption 6 kgeqCO2/m²
min annual energy consumption cost EUR 456
max annual energy consumption cost EUR 618
energy consumption reference date 01/01/2021

distance, meters

closest subway station Jules Joffrin
subway 50

