

# 28 rue Hermel

75018 Paris  
floor 5 out of 7  
171.79 sqft  
15.96 sqm  
available from now on

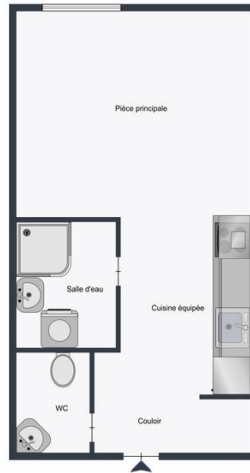

+33 7 88 29 46 18

## rent

base rent	EUR 536
additional rent	EUR 394
operational costs	EUR 35
total rent	EUR 965
deposit	EUR 930
rent increase	33,6 EUR / sqm
reference	
notice period	one month

## apartment

built-in kitchen  
washing machine

## building

construction year	1900
-------------------	------

## energy

energy efficiency rating C	
date of certificate	08/07/2024
current energy consumption	214 kWh/m <sup>2</sup> *a
gas efficiency rating A	
current gas consumption	6 kgeqCO <sub>2</sub> /m <sup>2</sup>
min annual energy	EUR 370

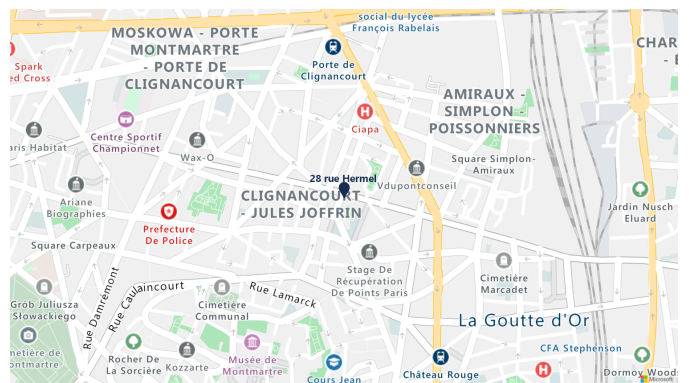

max annual energy                      EUR 530

consumption cost

energy 01/01/2021

consumption

reference date

distance, meters

closest subway                      Jules Joffrin

station

subway	50
--------	----

