

# 12/12 bis Cité d'Antin

75009 Paris  
341.33 sqft  
31.71 sqm  
available from now on

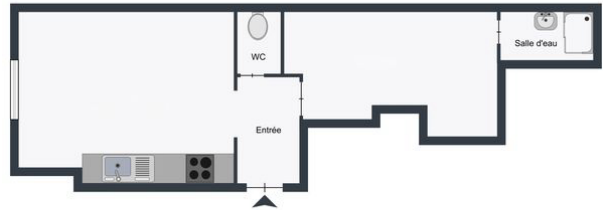

+33 7 88 29 46 18

## rent

base rent	EUR 1 278
operational costs	EUR 101
total rent	EUR 1 379
deposit	EUR 1 278
rent increase reference	42,1 EUR / sqm
notice period	one month

## apartment

store room  
built-in kitchen  
dishwasher  
washing machine

## building

construction year 1836

## energy

energy efficiency rating D	
date of certificate	13/05/2026
current energy consumption	218 kWh/m <sup>2</sup> *a
gas efficiency rating B	
current gas consumption	8 kgeqCO <sub>2</sub> /m <sup>2</sup>
min annual energy consumption cost	EUR 710



max annual energy  
consumption cost  
energy  
consumption  
reference date

EUR 990

01/01/2021

**distance, meters**

closest subway  
station  
subway

Chaussée d'Antin —  
La Fayette  
100





