

101 rue La Fayette

75010 Paris
floor 2 out of 6
bedrooms 2
609.03 sqft
56.58 sqm
available from now on

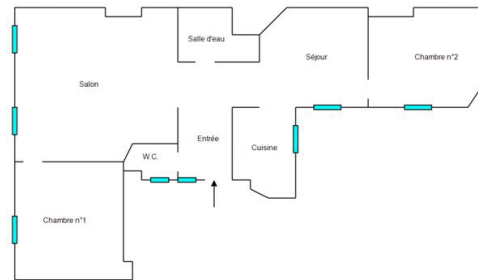

+33 7 85 99 37 74

rent

base rent	EUR 1 669
additional rent	EUR 383
operational costs	EUR 150
total rent	EUR 2 202
deposit	EUR 2 052
rent increase reference	29,5 EUR / sqm

apartment

flooring	parquet
store room	
built-in kitchen	
dishwasher	
washing machine	

building

construction year	1900
-------------------	------

energy

energy efficiency rating E	
date of certificate	27/01/2026
current energy consumption	288 kWh/m ² *a
gas efficiency rating C	
current gas	11 kgeqCO ₂ /m ²



consumption
min annual energy
consumption cost
EUR 1 530
max annual energy
consumption cost
EUR 2 100
energy
consumption
reference date
01/01/2021

distance, meters
closest subway
station
Poissonière
subway
100





