

# 6 place Félix Eboué

75012 Paris  
floor 3 out of 7  
191.71 sqft  
17.81 sqm  
available from 09/09/2024

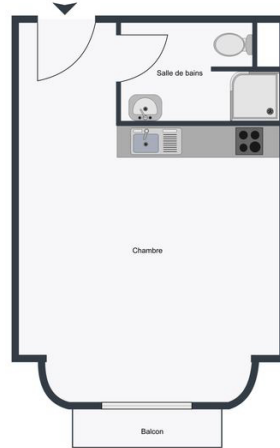

+33 6 43 36 03 24

## rent

base rent	EUR 599
additional rent	EUR 316
operational costs	EUR 45
total rent	EUR 960
deposit	EUR 915
rent increase	33,6 EUR / sqm
reference	

## apartment

flooring	parquet
store room	
balcony	
built-in kitchen	
washer dryer	

## building

construction year	1900
bike room	
elevator	

## energy

energy efficiency rating E	
date of certificate	08/04/2019
current energy consumption	321 kWh/m <sup>2</sup> *a

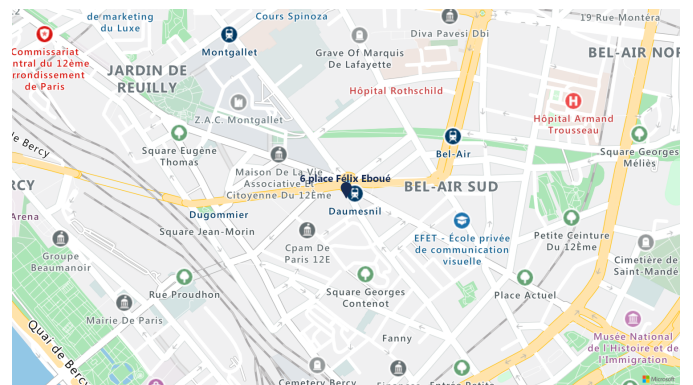

gas efficiency rating B  
current gas consumption 8 kgeqCO<sub>2</sub>/m<sup>2</sup>  
annual energy consumption cost EUR 641  
energy consumption reference date 17/04/2017

distance, meters

closest subway station Daumesnil

