

119 avenue d'Ivry

75013 Paris
floor 4 out of 6
194.72 sqft
18.09 sqm
available from now on

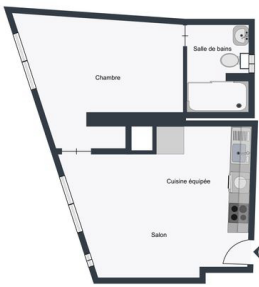

+33 6 43 36 03 24

rent

base rent	EUR 760
operational costs	EUR 70
total rent	EUR 830
deposit	EUR 760
rent increase	34,1 EUR / sqm
reference	

apartment

flooring	parquet
store room	
built-in kitchen	
dishwasher	
washing machine	

building

construction year	1900
-------------------	------

energy

energy efficiency rating C	
date of certificate	07/10/2025
current energy consumption	305 kWh/m²*a
gas efficiency rating B	
current gas consumption	9 kgeqCO2/m²
min annual energy	EUR 510



consumption cost
max annual energy
consumption cost
energy
consumption
reference date

distance, meters

closest subway
station

EUR 720

01/01/2023

Tolbiac





