

11 bis rue de l'Amiral Mouchez

75013 Paris
floor 3 out of 5
bedrooms 1
399.34 sqft
37.10 sqm
available from now on

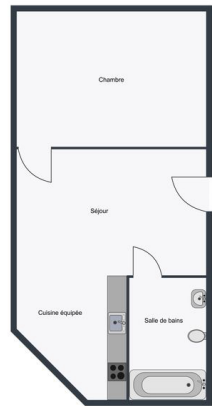

+33 6 43 36 03 24

rent

base rent	EUR 1 458
operational costs	EUR 85
total rent	EUR 1 543
deposit	EUR 1 458
rent increase	32,4 EUR / sqm
reference	

apartment

flooring	parquet
built-in kitchen	
dishwasher	
washing machine	

building

construction year	1900
bike room	
elevator	

energy

energy efficiency rating E	
date of certificate	12/09/2025
current energy consumption	272 kWh/m ² *a
gas efficiency rating B	
current gas	8 kgeqCO ₂ /m ²



consumption
min annual energy
consumption cost
max annual energy
consumption cost
energy
consumption
reference date

distance, meters

closest subway
station

EUR 830

EUR 1 160

01/01/2023

Glacière





