

# 11bis rue de l'Amiral Mouchez

75013 Paris  
floor 4 out of 6  
237.67 sqft  
22.08 sqm  
available from now on

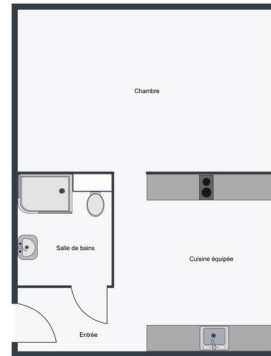

+33 7 85 99 37 74

## rent

base rent	EUR 847
additional rent	EUR 346
operational costs	EUR 50
total rent	EUR 1 243
deposit	EUR 1 193
rent increase reference	38,4 EUR / sqm

## apartment

flooring	parquet
built-in kitchen	
washing machine	

## building

construction year	1900
bike room	

## energy

energy efficiency rating C	
date of certificate	23/02/2026
current energy consumption	218 kWh/m <sup>2</sup> *a
gas efficiency rating B	
current gas consumption	8 kgeqCO <sub>2</sub> /m <sup>2</sup>
min annual energy	EUR 530



consumption cost  
max annual energy  
consumption cost EUR 760  
energy consumption  
reference date 01/01/2021

**distance, meters**

closest subway  
station Glaciere  
subway 750





