

11 bis rue de l'Amiral Mouchez

75013 Paris
floor 4 out of 6
235.95 sqft
21.92 sqm
available from now on

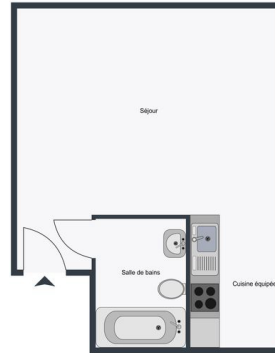

+33 6 43 36 03 24

rent

base rent	EUR 815
additional rent	EUR 245
operational costs	EUR 70
total rent	EUR 1 130
deposit	EUR 1 060
rent increase	37,2 EUR / sqm
reference	

apartment

flooring	parquet
built-in kitchen	
washer dryer	

building

construction year	1900
bike room	

energy

energy efficiency rating E	
date of certificate	14/04/2025
current energy consumption	297 kWh/m²*a
gas efficiency rating B	
current gas consumption	9 kgeqCO2/m²
min annual energy	EUR 580

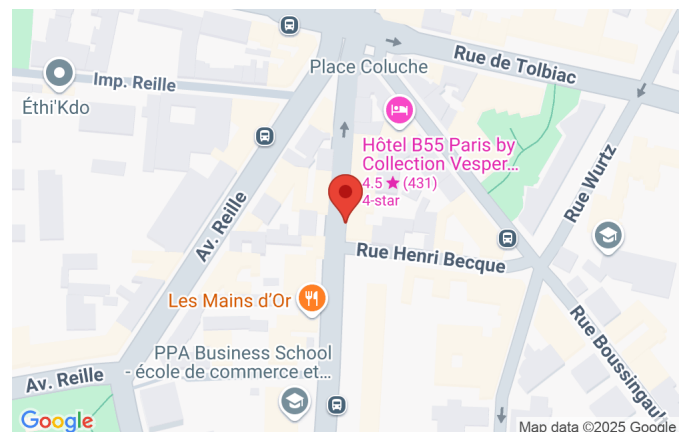

consumption cost
max annual energy
consumption cost
energy
consumption
reference date

EUR 830
01/01/2021

distance, meters

closest subway
station
subway

Glacière
750



