

# 16 rue Manin

75019 Paris  
bedrooms 1  
290.63 sqft  
27.00 sqm  
available from now on

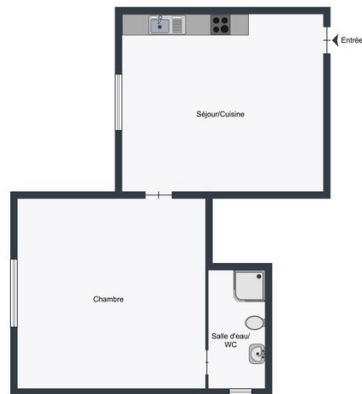

+33 6 43 36 03 24

## rent

base rent	EUR 759
additional rent	EUR 219
operational costs	EUR 50
total rent	EUR 1 028
deposit	EUR 978
rent increase	28,1 EUR / sqm
reference	

## apartment

flooring	parquet
built-in kitchen	
washing machine	

## building

construction year	1908
-------------------	------

## energy

energy efficiency rating F	
date of certificate	27/04/2021
current energy consumption	451 kWh/m <sup>2</sup> *a
housing with excessive energy consumption	class F
gas efficiency rating D	



current gas consumption 30 kgeqCO2/m<sup>2</sup>  
annual energy consumption cost EUR 1 453  
energy consumption reference date 01/01/2019

distance, meters

closest subway station Ourcq station



