

# 16 ter rue Olivier Métra

75020 Paris  
203.12 sqft  
18.87 sqm  
available from now on

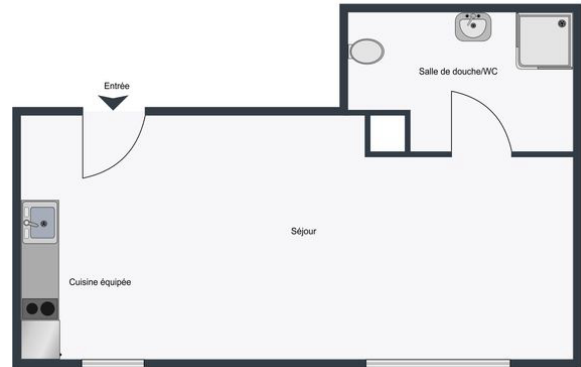

+33 7 84 39 18 01

## rent

base rent	EUR 670
additional rent	EUR 163
operational costs	EUR 85
total rent	EUR 918
deposit	EUR 833
rent increase reference	35,5 EUR / sqm
notice period	one month

## apartment

flooring	parquet
built-in kitchen	
washer dryer	

## building

construction year	1926
-------------------	------

## energy

energy efficiency rating E	
date of certificate	02/02/2023
current energy consumption	325 kWh/m <sup>2</sup> *a
gas efficiency rating B	
current gas consumption	10 kgeqCO <sub>2</sub> /m <sup>2</sup>
min annual energy consumption cost	EUR 447



max annual energy  
consumption cost  
energy  
consumption  
reference date

EUR 605

01/01/2021

**distance, meters**

closest subway  
station

Jourdain





