

27 rue Voltaire

93400 Saint-Ouen
floor 1 out of 6
185.79 sqft
17.26 sqm
available from now on

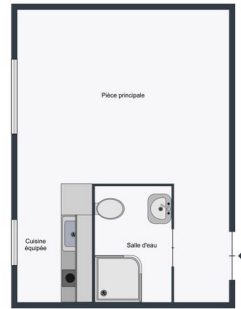

+33 6 38 45 54 34

rent

base rent	EUR 495
additional rent	EUR 203
operational costs	EUR 45
total rent	EUR 743
deposit	EUR 698
rent increase	28,7 EUR / sqm
reference	

apartment

flooring	parquet
built-in kitchen	
washing machine	

building

construction year	1940
-------------------	------

energy

energy efficiency rating E	
date of certificate	28/10/2025
current energy consumption	387 kWh/m²*a
gas efficiency rating B	
current gas consumption	12 kgeqCO2/m²
min annual energy consumption cost	EUR 590



max annual energy consumption cost
EUR 820
energy consumption
01/01/2021
reference date

distance, meters

closest subway station
Porte de Cligancourt



