

27 rue Voltaire

93400 Saint-Ouen
floor 2 out of 8
bedrooms 1
184.49 sqft
17.14 sqm
available from now on

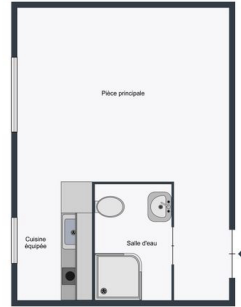

+33 6 38 45 54 34

rent

base rent	EUR 492
additional rent	EUR 218
operational costs	EUR 50
total rent	EUR 760
deposit	EUR 710
rent increase	28,7 EUR / sqm
reference	

apartment

flooring	parquet
built-in kitchen	
washer dryer	

building

construction year	1940
-------------------	------

energy

energy efficiency rating E	
date of certificate	18/11/2025
current energy consumption	329 kWh/m ² *a
gas efficiency rating B	
current gas consumption	10 kgeqCO ₂ /m ²
min annual energy	EUR 454



consumption cost	
max annual energy	EUR 614
consumption cost	
energy	01/01/2021
consumption	
reference date	

distance, meters

closest subway station	Porte de clignancourt
subway	800





