

6 rue Christophe Colomb

94200 Ivry-sur-Seine
floor 2 out of 6
154.36 sqft
14.34 sqm
available from now on

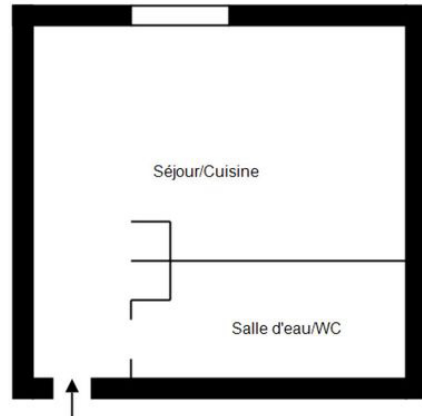

+33 7 84 39 18 01

rent

base rent	EUR 663
operational costs	EUR 35
total rent	EUR 698
deposit	EUR 663

apartment

flooring	pvc
store room	
built-in kitchen	

building

construction year	1940
-------------------	------

energy

energy efficiency rating D	
date of certificate	05/05/2020
current energy consumption	200 kWh/m ² *a
gas efficiency rating B	
current gas consumption	6 kgeqCO ₂ /m ²
annual energy consumption cost	EUR 406
energy consumption	01/01/2020



reference date

distance, meters

closest subway station Pierre et Marie Curie
subway 750

