

# 6 rue Christophe Colomb

94200 Ivry-sur-Seine  
bedrooms 1  
330.99 sqft  
30.75 sqm  
available from now on

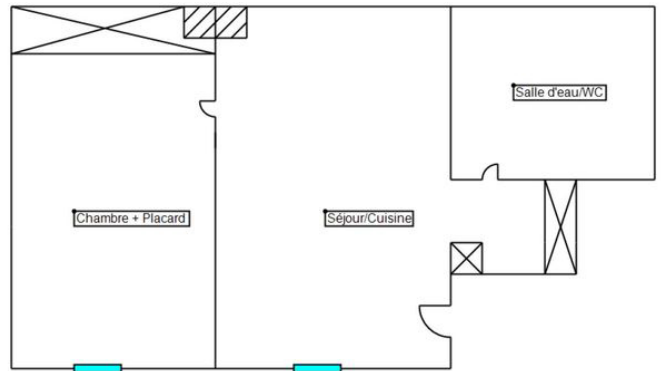

+33 7 84 39 18 01

## rent

base rent	EUR 826
operational costs	EUR 50
total rent	EUR 876
deposit	EUR 826
notice period	one month

## apartment

flooring	parquet
store room	

## building

construction year	1940
-------------------	------

## energy

energy efficiency rating D	
date of certificate	13/03/2025
current energy consumption	245 kWh/m <sup>2</sup> *a
gas efficiency rating B	
current gas consumption	9 kgeqCO <sub>2</sub> /m <sup>2</sup>
min annual energy consumption cost	EUR 760
max annual energy consumption cost	EUR 1 070
energy	01/01/2023

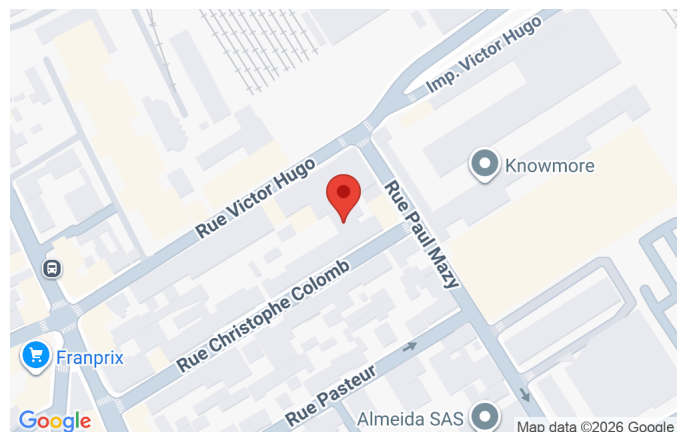

consumption  
reference date

## distance, meters

closest subway station	Pierre et Marie Curie
subway	650



