

6 rue Christophe Colomb

94200 Ivry-sur-Seine
floor 2 out of 3
225.18 sqft
20.92 sqm
available from now on

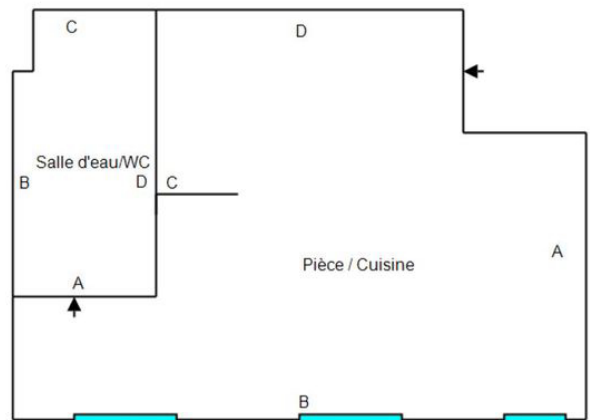

+33 7 84 39 18 01

rent

base rent	EUR 775
operational costs	EUR 25
total rent	EUR 800
deposit	EUR 775
notice period	one month

apartment

flooring	parquet
built-in kitchen	

building

construction year	1940
-------------------	------

energy

energy efficiency rating E	
date of certificate	10/12/2024
current energy consumption	344 kWh/m²*a
gas efficiency rating B	
current gas consumption	10 kgeqCO2/m²
min annual energy consumption cost	EUR 638
max annual energy consumption cost	EUR 864
energy	01/01/2023



consumption
reference date

distance, meters

closest subway station
Pierre et Marie Curie
subway 650



