

6 rue Christophe Colomb

94200 Ivry-sur-Seine
floor 2 out of 3
183.42 sqft
17.04 sqm
available from now on

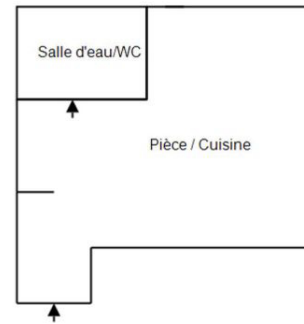

+33 7 84 39 18 01

rent

base rent	EUR 672
operational costs	EUR 38
total rent	EUR 710
deposit	EUR 672

apartment

flooring	parquet
store room	

building

construction year	1940
-------------------	------

energy

energy efficiency rating D	
date of certificate	10/04/2025
current energy consumption	308 kWh/m ² *a
gas efficiency rating B	
current gas consumption	9 kgeqCO ₂ /m ²
min annual energy consumption cost	EUR 500
max annual energy consumption cost	EUR 690
energy consumption	01/01/2023

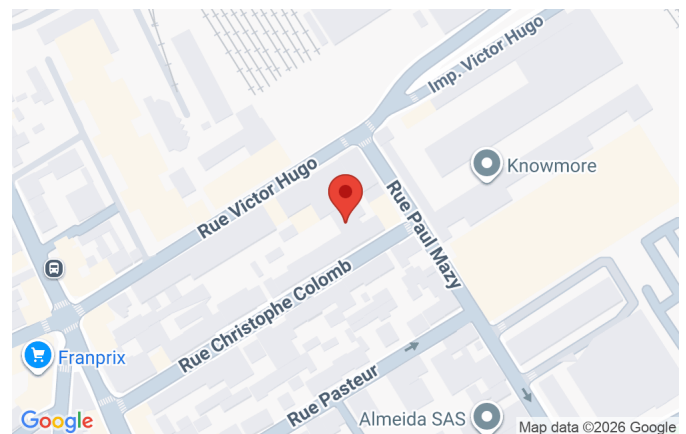

reference date

distance, meters

closest subway station	Pierre et Marie Curie
subway	650



