

6 rue Christophe Colomb

94200 Ivry-sur-Seine
floor 2 out of 3
bedrooms 1
418.07 sqft
38.84 sqm
available from now on

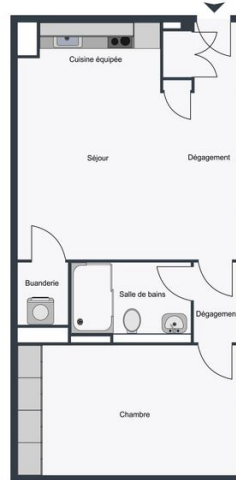

+33 7 84 39 18 01

rent

base rent
operational costs
total rent
deposit
notice period

EUR 1 200
EUR 55
EUR 1 255
EUR 1 200
one month

apartment

flooring
store room
built-in kitchen
dishwasher
washer dryer

parquet

building

construction year

1940

energy

energy efficiency rating E
date of certificate
current energy
consumption
gas efficiency rating A
current gas
consumption

12/02/2020
235 kWh/m²*a
5 kgeqCO₂/m²



annual energy
consumption cost

EUR 444

energy
consumption
reference date

11/02/2018

distance, meters

closest subway
station
subway

Pierre et Marie Curie

650



