

2 rue Pasteur

92110 Clichy-La-Garenne
floor 3 out of 5
271.04 sqft
25.18 sqm
available from now on

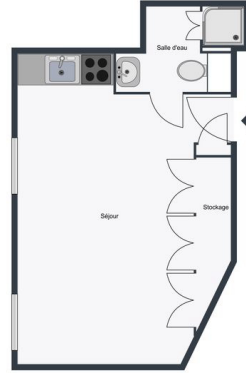

+33 6 38 45 54 34

rent

base rent	EUR 857
operational costs	EUR 60
total rent	EUR 917
deposit	EUR 857
notice period	one month

apartment

flooring	parquet
store room	
built-in kitchen	
washing machine	

building

construction year	1908
-------------------	------

energy

energy efficiency rating C	
date of certificate	10/11/2021
current energy consumption	148 kWh/m ² *a
gas efficiency rating A	
current gas consumption	4 kgeqCO ₂ /m ²
min annual energy consumption cost	EUR 321
max annual energy	EUR 435



consumption cost
energy
consumption
reference date

08/10/2021

distance, meters

closest subway
station

Mairie de Clichy



