

2 rue Pasteur

92110 Clichy-La-Garenne

floor 4 out of 5

270.61 sqft

25.14 sqm

available from now on

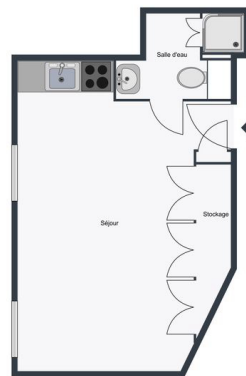

+33 6 38 45 54 34

rent

base rent

EUR 828

operational costs

EUR 50

total rent

EUR 878

deposit

EUR 828

notice period

one month

apartment

flooring

parquet

store room

built-in kitchen

washer dryer

building

construction year

1908

energy

energy efficiency rating C

date of certificate

01/08/2024

current energy

158 kWh/m²*a

consumption

gas efficiency rating A

current gas

4 kgeqCO₂/m²

consumption

min annual energy

EUR 412

consumption cost

max annual energy

EUR 558



consumption cost
energy
consumption
reference date

01/01/2021

distance, meters

closest subway
station
subway

Mairie de Clichy

300



