

7 rue Tintoret

92600 Asnières-sur-Seine

floor 1 out of 7

230.03 sqft

21.37 sqm

available from now on

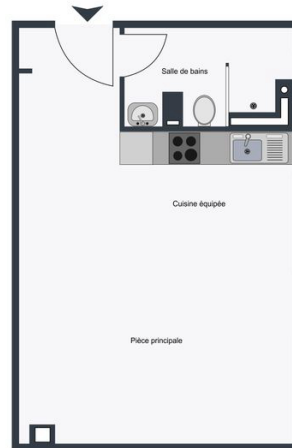

+33 7 56 00 79 60

rent

base rent

EUR 819

operational costs

EUR 35

total rent

EUR 854

deposit

EUR 819

notice period

one month

apartment

flooring

parquet

built-in kitchen

washer dryer

building

construction year

1920

energy

energy efficiency rating E

date of certificate

07/01/2020

current energy

281 kWh/m²*a

consumption

gas efficiency rating B

current gas

6 kgeqCO₂/m²

consumption

annual energy

EUR 390

consumption cost

energy

15/08/2015



consumption
reference date

distance, meters

closest subway station
Bécon les Bruyères
subway 200



