

7 rue Tintoret

92600 Asnières-sur-Seine
floor 2 out of 5
bedrooms 2
584.16 sqft
54.27 sqm
available from now on

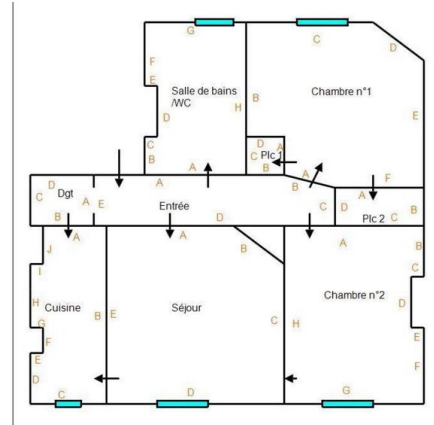

+33 6 38 45 54 34

rent

base rent	EUR 1 420
operational costs	EUR 115
total rent	EUR 1 535
deposit	EUR 1 420

apartment

flooring	parquet
store room	
built-in kitchen	
washing machine	

building

construction year	1920
-------------------	------

energy

energy efficiency rating E	
date of certificate	07/10/2025
current energy consumption	268 kWh/m²*a
gas efficiency rating B	
current gas consumption	8 kgeqCO2/m²
min annual energy consumption cost	EUR 1 130
max annual energy consumption cost	EUR 1 570



consumption cost
energy
consumption
reference date

01/01/2021

distance, meters

closest subway
station
subway

Bécon les Bruyères

100



