

7 rue Tintoret

92600 Asnières-sur-Seine
floor 2 out of 5
bedrooms 1
236.16 sqft
21.94 sqm
available from now on

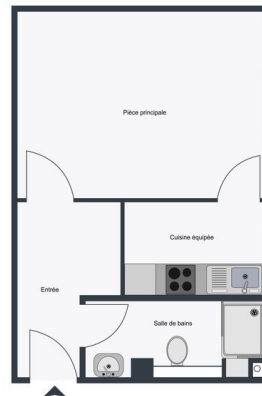

+33 6 38 45 54 34

rent

base rent
operational costs
total rent
deposit

EUR 875
EUR 35
EUR 910
EUR 875

apartment

flooring
built-in kitchen
separate kitchen
washer dryer

parquet

building

construction year 1920

energy

energy efficiency rating C
date of certificate
current energy
consumption

28/03/2025
167 kWh/m²*a

gas efficiency rating A
current gas
consumption

4 kgeqCO₂/m²

min annual energy
consumption cost

EUR 380

max annual energy

EUR 560



consumption cost
energy
consumption
reference date

01/01/2021

distance, meters

closest subway
station
subway

Bécon les Bruyères

200



