

7 rue Tintoret

92600 Asnières-sur-Seine
floor 5 out of 7
bedrooms 1
328.41 sqft
30.51 sqm
available from now on

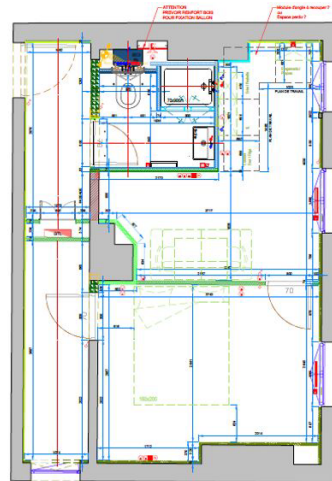

+33 7 88 98 91 04

rent

base rent
operational costs
total rent
deposit
notice period

EUR 940
EUR 50
EUR 990
EUR 940
one month

apartment

flooring
built-in kitchen

parquet

building

construction year

1920

energy

energy efficiency rating D
date of certificate
current energy
consumption
gas efficiency rating B
current gas
consumption
annual energy
consumption cost
energy

28/12/2020
214 kWh/m²*a
6 kgeqCO₂/m²
EUR 474
15/08/2015

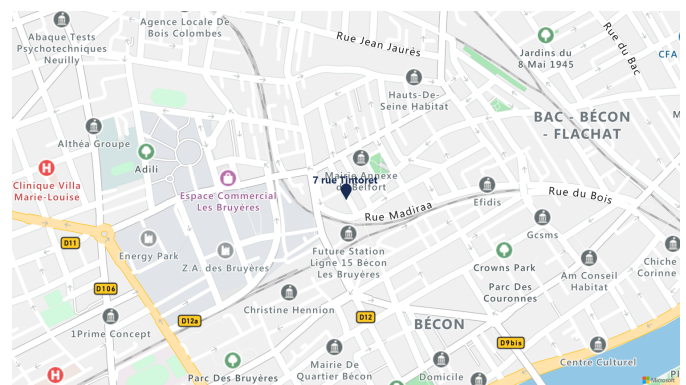

consumption
reference date

distance, meters

closest subway
station
subway

Bécon les Bruyères

100



