

# 6 rue de l'Orme

75019 paris  
floor 2 out of 8  
bedrooms 2  
552.41 sqft  
51.32 sqm  
available from now on

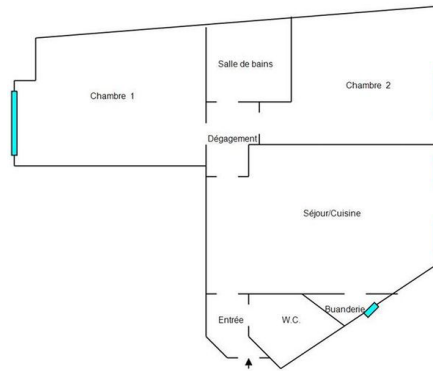

+33 7 85 99 37 74

## rent

base rent	EUR 1 350
operational costs	EUR 80
total rent	EUR 1 430
deposit	EUR 1 350
rent increase	26,3 EUR / sqm
reference	

## apartment

flooring	parquet
built-in kitchen	

## building

construction year	1908
-------------------	------

## energy

energy efficiency rating D	
date of certificate	24/04/2026
current energy consumption	207 kWh/m <sup>2</sup> *a
gas efficiency rating B	
current gas consumption	7 kgeqCO <sub>2</sub> /m <sup>2</sup>
min annual energy consumption cost	EUR 1 040
max annual energy	EUR 1 470



consumption cost  
energy  
consumption  
reference date

01/01/2021

**distance, meters**

closest subway  
station

télégraphe



