

18 rue de l'Église

92300 Neuilly-sur-Seine
floor 1 out of 6
256.18 sqft
23.80 sqm
available from now on

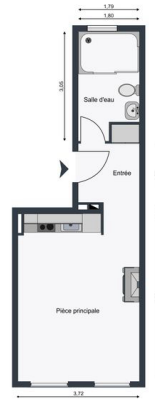

+33 7 88 29 46 18

rent

base rent	EUR 1 111
operational costs	EUR 90
total rent	EUR 1 201
deposit	EUR 1 111

apartment

flooring	parquet
built-in kitchen	
microwave	
washing machine	

building

construction year	1930
-------------------	------

energy

energy efficiency rating E	
date of certificate	27/06/2022
current energy consumption	281 kWh/m ² *a
gas efficiency rating B	
current gas consumption	8 kgeqCO ₂ /m ²
min annual energy consumption cost	EUR 479
max annual energy consumption cost	EUR 647



energy
consumption
reference date

01/01/2021

distance, meters

closest subway
station

Pont de Neuilly



