

18 rue de l'Église

92200 Neuilly-sur-Seine
floor 1 out of 6
bedrooms 2
474.91 sqft
44.12 sqm
available from now on

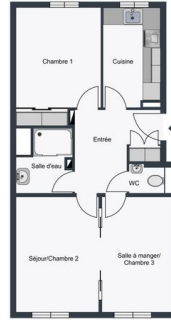

+33 6 38 45 54 34

rent

base rent	EUR 2 015
operational costs	EUR 120
total rent	EUR 2 135
deposit	EUR 2 015

apartment

flooring	parquet
store room	
built-in kitchen	
separate kitchen	
dishwasher	
microwave	
washing machine	

building

construction year	1930
elevator	

energy

energy efficiency rating D	
date of certificate	27/06/2022
current energy consumption	207 kWh/m ² *a
gas efficiency rating B	
current gas	6 kgeqCO ₂ /m ²



consumption
min annual energy
consumption cost EUR 616
max annual energy
consumption cost EUR 834
energy
consumption
reference date 01/01/2021

distance, meters

closest subway
station Pont de Neuilly
subway 400



