

# 18 rue de l'Église

92200 Neuilly-sur-Seine  
floor 2 out of 6  
259.20 sqft  
24.08 sqm  
available from now on

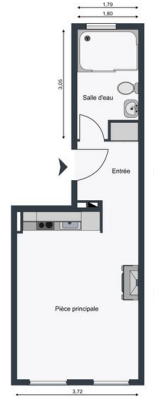

+33 7 88 29 46 18

## rent

base rent	EUR 1 029
operational costs	EUR 90
total rent	EUR 1 119
deposit	EUR 1 029

## apartment

flooring	parquet
store room	
built-in kitchen	
washing machine	

## building

construction year	1930
-------------------	------

## energy

energy efficiency rating E	
date of certificate	27/06/2022
current energy consumption	273 kWh/m <sup>2</sup> *a
gas efficiency rating B	
current gas consumption	8 kgeqCO <sub>2</sub> /m <sup>2</sup>
min annual energy consumption cost	EUR 473
max annual energy consumption cost	EUR 641



energy  
consumption  
reference date

01/01/2021

**distance, meters**

closest subway  
station  
subway

Pont de Neuilly

350





