

18 rue de l'Eglise

92200 Neuilly-sur-Seine

floor 5 out of 6

bedrooms 2

482.01 sqft

44.78 sqm

available from now on

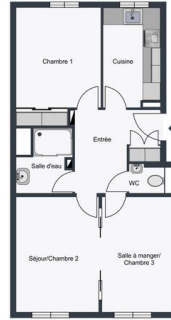

+33 6 38 45 54 34

rent

base rent

EUR 1 892

operational costs

EUR 180

total rent

EUR 2 072

deposit

EUR 1 892

apartment

separate kitchen

microwave

washing machine

building

construction year

1930

elevator

energy

energy efficiency rating D

date of certificate

27/06/2022

current energy

227 kWh/m²*a

consumption

gas efficiency rating B

current gas

7 kgeqCO₂/m²

consumption

min annual energy

EUR 673

consumption cost

max annual energy

EUR 911



consumption cost
energy
consumption
reference date

01/01/2021

distance, meters

closest subway
station

Pont de Neuilly



