

10 Borey 8-10 rue Elisa Borey

75020 Paris
bedrooms 2
438.09 sqft
40.70 sqm
available from 19/08/2024

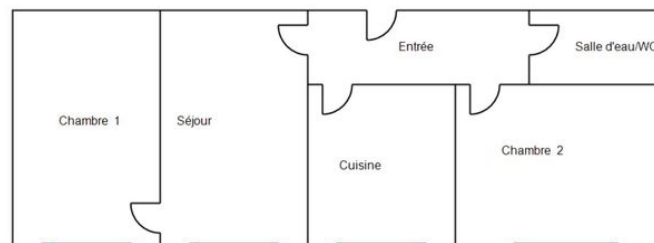

+33 6 38 45 54 34

rent

base rent	EUR 1 034
operational costs	EUR 105
total rent	EUR 1 139
deposit	EUR 1 034
rent increase reference	25,4 EUR / sqm
notice period	one month

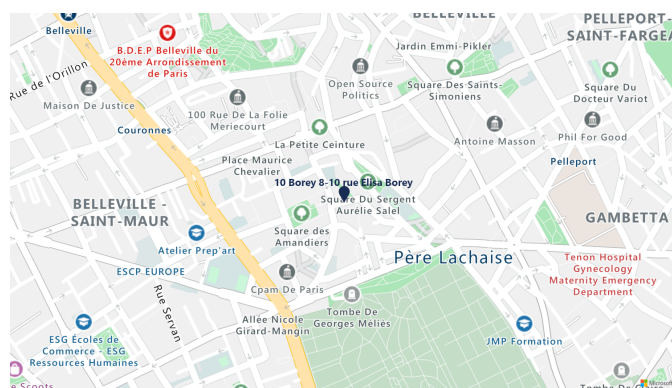

apartment

separate kitchen

building

construction year 1907

energy

energy efficiency rating D	
date of certificate	04/08/2024
current energy consumption	248 kWh/m ² *a
gas efficiency rating B	
current gas consumption	7 kgeqCO ₂ /m ²
min annual energy consumption cost	EUR 841
max annual energy	EUR 1 137

consumption cost
energy
consumption
reference date

01/01/2023

distance, meters

closest subway
station
subway

Père-Lachaise

700

