

10 Borey 8-10 rue Elisa Borey

75020 Paris
bedrooms 1
335.41 sqft
31.16 sqm
available from now on

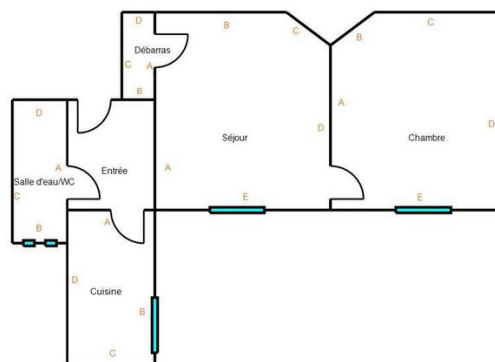

+33 7 84 39 18 01

rent

| | |
|-------------------|----------------|
| base rent | EUR 919 |
| operational costs | EUR 55 |
| total rent | EUR 974 |
| deposit | EUR 919 |
| rent increase | 29,5 EUR / sqm |
| reference | |
| notice period | one month |

apartment

| | |
|------------------|---------|
| flooring | parquet |
| store room | |
| separate kitchen | |

building

| | |
|-------------------|------|
| construction year | 1907 |
|-------------------|------|

energy

| | |
|------------------------------------|--|
| energy efficiency rating E | |
| date of certificate | 12/08/2021 |
| current energy consumption | 324 kWh/m ² *a |
| gas efficiency rating B | |
| current gas consumption | 10 kgeqCO ₂ /m ² |
| min annual energy consumption cost | EUR 882 |



max annual energy consumption cost
energy consumption reference date

EUR 1 194
01/01/2021

distance, meters

closest subway station
subway

Père Lachaise
500



