

10 Borey 8-10 rue Elisa Borey

75020 Paris
floor 2 out of 6
bedrooms 1
327.23 sqft
30.40 sqm
available from 29/07/2024

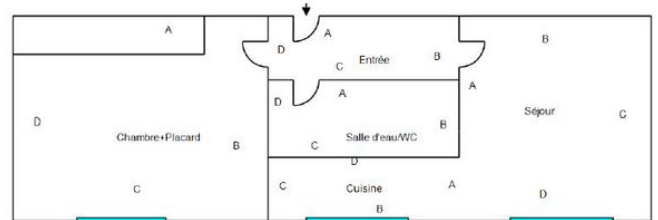

+33 6 38 45 54 34

rent

| | |
|-------------------|----------------|
| base rent | EUR 870 |
| additional rent | EUR 180 |
| operational costs | EUR 60 |
| total rent | EUR 1 110 |
| deposit | EUR 1 050 |
| rent increase | 28,6 EUR / sqm |
| reference | |

apartment

| | |
|------------------|---------|
| flooring | parquet |
| store room | |
| built-in kitchen | |
| washing machine | |

building

| | |
|-------------------|------|
| construction year | 1907 |
| bike room | |

energy

| | |
|----------------------------|---------------------------------------|
| energy efficiency rating D | |
| date of certificate | 27/12/2021 |
| current energy consumption | 199 kWh/m ² *a |
| gas efficiency rating B | |
| current gas | 6 kgeqCO ₂ /m ² |

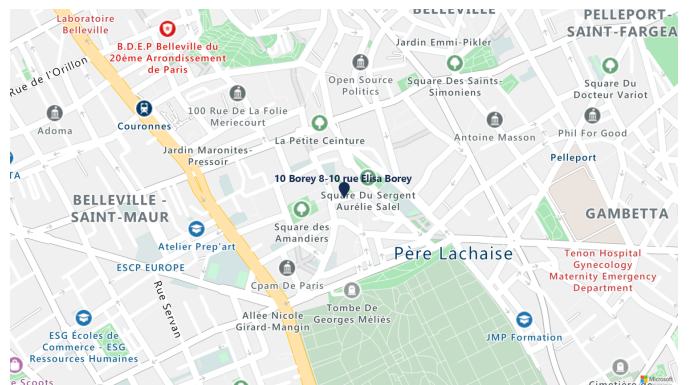

consumption
min annual energy consumption cost EUR 608
max annual energy consumption cost EUR 822
energy consumption reference date 01/01/2021

distance, meters

closest subway station Père Lachaise

