

60 rue Louis Bertrand

94200 Ivry-sur-Seine
floor 1 out of 4
bedrooms 1
492.45 sqft
45.75 sqm
available from now on

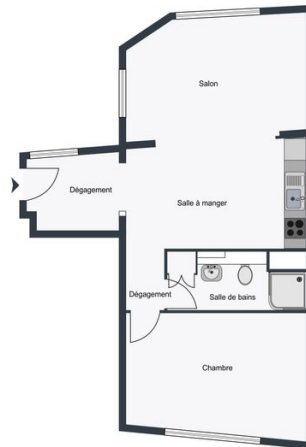

+33 7 84 39 18 01

rent

base rent
operational costs
total rent
deposit
notice period

EUR 1 400
EUR 90
EUR 1 490
EUR 1 400
one month

apartment

flooring
store room
built-in kitchen
dishwasher
microwave
washing machine

parquet

building

construction year
bike room

1910

energy

energy efficiency rating D
date of certificate
current energy
consumption
gas efficiency rating A

10/04/2024
185 kWh/m²*a

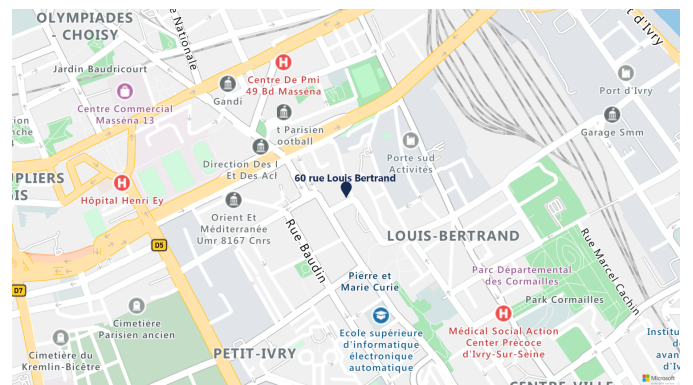

current gas consumption 5 kgeqCO2/m²
min annual energy consumption cost EUR 560
max annual energy consumption cost EUR 790
energy consumption reference date 01/01/2021

distance, meters

closest subway station Pierre et Marie Curie
subway 350



