

# 60 rue Louis Bertrand

94200 Ivry-sur-Seine  
bedrooms 1  
458.55 sqft  
42.60 sqm  
available from now on

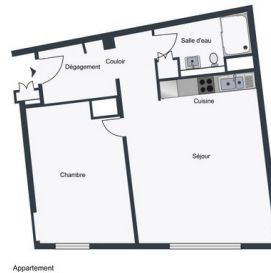

+33 6 43 36 03 24

## rent

base rent	EUR 1 170
operational costs	EUR 85
total rent	EUR 1 255
deposit	EUR 1 170
notice period	one month

## apartment

flooring	parquet
store room	
built-in kitchen	
dishwasher	
microwave	
washing machine	

## building

construction year	1910
-------------------	------

## energy

energy efficiency rating C	
date of certificate	10/04/2024
current energy consumption	162 kWh/m <sup>2</sup> *a
gas efficiency rating A	
current gas consumption	5 kgeqCO <sub>2</sub> /m <sup>2</sup>
min annual energy	EUR 480



consumption cost  
max annual energy consumption cost  
energy consumption reference date  
EUR 680  
01/01/2021

**distance, meters**

closest subway station  
subway  
Pierre et Marie Curie  
350





