

33 rue Lamarck

75018 Paris
floor 4 out of 7
bedrooms 2
716.99 sqft
66.61 sqm
available from now on

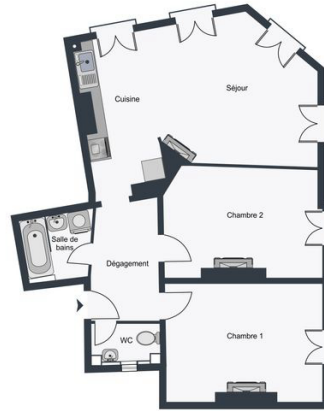

+33 7 88 29 46 18

rent

base rent	EUR 1 825
additional rent	EUR 442
operational costs	EUR 168
total rent	EUR 2 435
deposit	EUR 2 267
rent increase reference	27,4 EUR / sqm
notice period	one month

apartment

flooring	parquet
built-in kitchen	
dishwasher	
washing machine	

building

construction year	1893
-------------------	------

energy

energy efficiency rating C	
date of certificate	04/12/2024
current energy consumption	147 kWh/m ² *a
gas efficiency rating C	

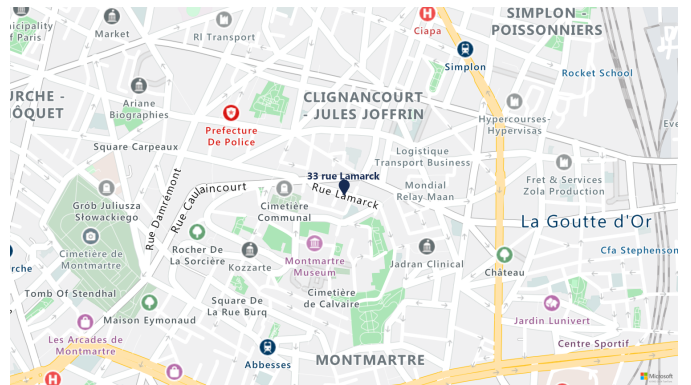

current gas consumption 29 kgeqCO2/m²
min annual energy consumption cost EUR 1 000
max annual energy consumption cost EUR 1 352
energy consumption reference date 01/01/2021

distance, meters

closest subway station Lamarck-Caulaincourt
subway 300
daily shop 150
school 100



