

# Elise-Averdieck-Straße 27

## 20535 Hamburg



available from now on  
total rent EUR 854,2

### rent EUR

base rent	704,2
operational costs	110
heating costs	40
total rent	854,2
deposit	2.112,6

### building

construction year	1957
floors	3
garden	communal garden

### apartment

apartment type	ground floor
rooms	1
size	37,08 m <sup>2</sup>
heating type	district heating
utility room	✓
balcony	✓

### energy

energy performance type	consumption
energy source	district heating
energy efficiency rating	D
date of certificate	24.02.2020
valid until	24.02.2030
current energy consumption	120,6 kWh/ m <sup>2</sup> *a

fully integrated kitchen



washing machine



## distance m

bus

260

subway

350

GO train

650





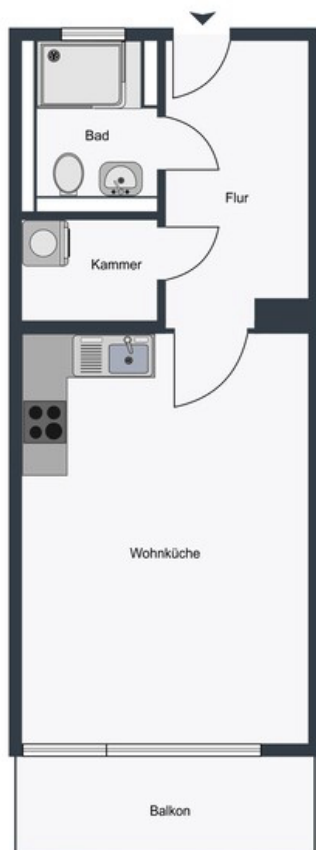





## comments

---

---

---