

Reismühle 10

22087 Hamburg



available from now on
total rent EUR 652,87

rent EUR

base rent	542,87
operational costs	70
heating costs	40
total rent	652,87
deposit	1.628,61

apartment

rooms	1
size	31,11 m ²
floor	2
heating type	gas floor heating
fully integrated kitchen	✓
washer-dryer	✓

building

construction year	1958
floors	3

energy

energy performance type	consumption
energy source	gas
energy efficiency rating	D
date of certificate	22.01.2018
valid until	22.01.2028
current energy consumption	152,4 kWh/ m ² *a

distance m

bus	400
subway	400
GO train	400



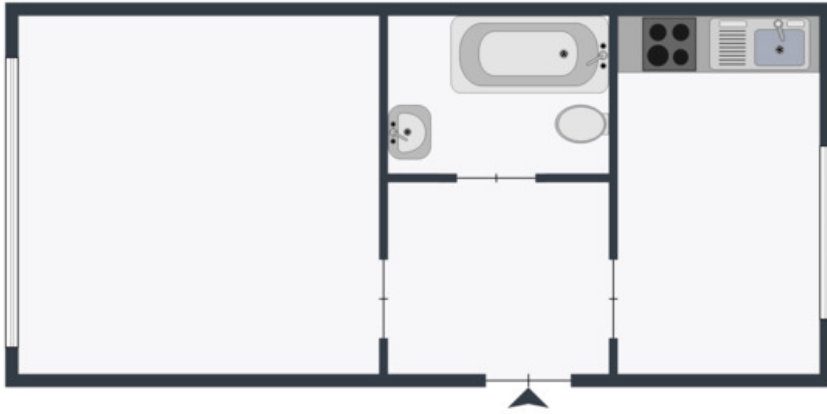



comments
